

# DOUBLE SEAL RECESSED MANHOLE COVER & FRAME DUCTILE IRON

**5 Years  
Warranty**

## SPECIFICATIONS

BRAND	
RANGE	- MANHOLE COVERS
PRODUCT CODE	- AX3030BR
PRODUCT TYPE	- SOLID TOP
MATERIAL	- DUCTILE IRON

## TECHNICAL INFORMATION

MANHOLE COVERS	
CLEAR OPENING (NORMAL)-	301X301
OVER BASE	- 450X450
DEPTH	- 70
LOADING	- B125

### FEATURES

- BS EN 124 LOADING
- DUCTILE IRON GJS 500-7
- DOUBLE SEAL
- BITUMEN COATED

BS EN 124 LOADING  
 DUCTILE IRON GJS 500-7  
 SINGLE SEAL  
 BADGING AS REQUIRED  
 BITUMEN COATED

## DRAWINGS

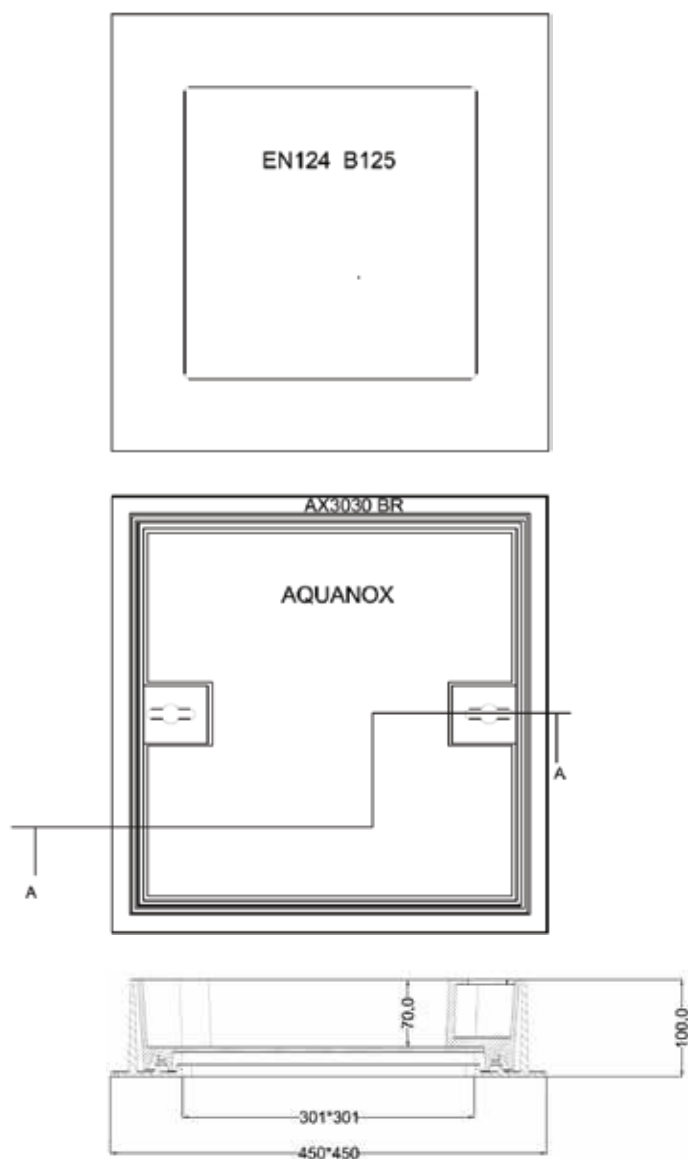

All dimensions in mm.  
 We reserve the rights to change the design/dimensions without any notice.

